

**EGTU AD 2.1** **EGTU** **DUNKESWELL**

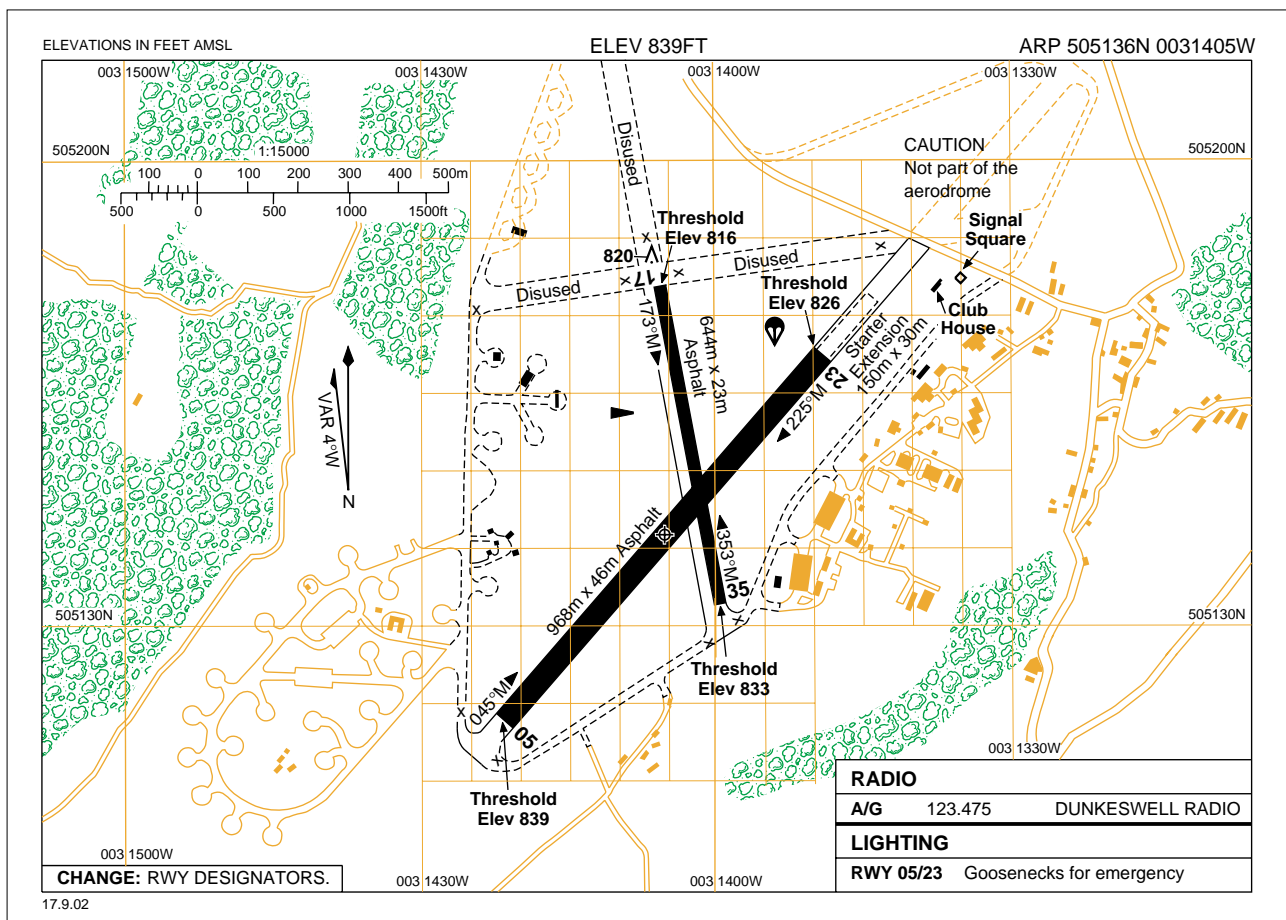

**EGTU AD 2.2 – AERODROME GEOGRAPHICAL AND ADMINISTRATIVE DATA**

<b>2</b>	<b>Direction and distance from city:</b>	14 nm NE of Exeter.
<b>5</b>	<b>AD Administration:</b>	Air Westward Ltd.
	<b>Address:</b>	Dunkeswell, Nr. Honiton, Devon, EX14 4LG.
	<b>Telephone:</b>	01404-891643 (Aerodrome); 01404-891271 (Licensee).
	<b>Fax:</b>	01404-891024 (Licensee); 01404-891465 (Aerodrome).

**EGTU AD 2.3 – OPERATIONAL HOURS**

→ <b>1</b>	<b>AD:</b>	<b>Winter:</b> 0900-1800 or SS + 30 whichever is earlier; and by arrangement. <b>Summer:</b> 0900-1700; and by arrangement.
→ <b>2</b>	<b>Customs and Immigration:</b>	By arrangement.
→ <b>7</b>	<b>ATS:</b>	<b>Winter:</b> A/G (ATZ) 0900-1800 or SS + 30 whichever is earlier. A/G also available by arrangement. <b>Summer:</b> A/G (ATZ) 0900-1700. A/G also available by arrangement.
→ <b>8</b>	<b>Fuelling:</b>	<b>Winter:</b> 0900-1800 or SS, whichever is earlier. Prior notice required. <b>Summer:</b> 0900-1700. Prior notice required.
<b>12</b>	<b>Remarks:</b>	This aerodrome is PPR. See also AD 2.20.

**EGTU AD 2.4 – HANDLING SERVICES AND FACILITIES**

<b>2</b>	<b>Fuel/oil types:</b>	Fuel: AVGAS 100LL. Jet A1.
----------	------------------------	----------------------------

EGTU AD 2.6 – RESCUE AND FIRE FIGHTING SERVICES	
1 AD Category for fire fighting:	RFF Category 1.

EGTU AD 2.10 – AERODROME OBSTACLES				
In Approach/Take-off areas			In circling area and at aerodrome	
1			2	
Runway/Area affected	Obstacle type Elevation (ft amsl) Markings/lighting	Co-ordinates	Obstacle type Elevation (ft amsl) Markings/lighting	Co-ordinates
a	b	c	a	b
17/Approach 35/Take-off	Fence	820	*505153.55N 0031405.65W	
3	Remarks:	Three Radio masts (See AD 2.20 Warnings): South side (Lgtd), 1007 ft amsl, *505105N 0031412W; North side, 79 ft agl, *505225N 0031349W; South of north side (Lgtd), 951 ft amsl, *505206N 0031359W. High ground southwest and within 2500 m radius of ARP 896 ft amsl *505045N 0031438W.		

EGTU AD 2.13 – DECLARED DISTANCES					
Runway Designator	TORA (m)	TODA (m)	ASDA (m)	LDA (m)	Remarks
1	2	3	4	5	6
05	968	968	968	968	† A starter extension of 150 x 30 m is available on request to the Aerodrome Manager. RWY 23 THR displaced by 295 metres.
23	968†	968†	968†	968	
17	644	644	644	644	
35	644	644	644	644	

EGTU AD 2.17 – ATS AIRSPACE		
Designation and lateral limits	Vertical limits	Airspace Classification
1	2	3
<b>Dunkeswell Aerodrome Traffic Zone (ATZ)</b> Circle radius 2 nm centred on longest notified runway (05/23) 505136N 0031405W.	<u>2000 ft aal</u> SFC	G †
4 <b>ATS unit callsign:</b> <b>Language:</b>	Dunkeswell Radio. English.	
6 <b>Remarks:</b>	† Refer to Section ENR 1.4 for Notifications. See AD 2.3 for ATZ hours.	

## EGTU AD 2.20 – LOCAL TRAFFIC REGULATIONS

**Aerodrome Regulations**

- (a) Aerodrome is not available at night for flights required to use a licensed aerodrome.
- (b) Aerodrome is not available at weekends & PH for helicopter training other than normal arrival/departures, due to free-fall parachuting.

**Warnings**

- (a) Glider launching takes place at North Hill (505107N 0031639W) West-south-west of Dunkeswell.
- (b) Free-fall parachuting from up to FL 150 normally during daylight hours (ENR 5-5-4-2 refers).
- (c) Use is made of the grass areas outside the runway strips for sheep grazing.
- (d) Outside the Northeast boundary of the aerodrome, and separated from it by a public road, is a large paved area. It is not part of the aerodrome. Pilots should positively identify the displaced landing threshold to Runway 23 before committing the aircraft to final approach.
- (e) The old perimeter tracks are unsuitable for use as a taxiway. Pilots are cautioned to only use established taxiways/runways for taxiing.
- (f) Pilots should note the existence of three radio masts erected by the MOD within the aerodrome circuit. They do not constitute a hazard but pilots should be aware of their presence.

## EGTU AD 2.21 – NOISE ABATEMENT PROCEDURES

- (a) Pilots are requested not to overfly Dunkeswell Village and local housing estate on eastern side of aerodrome below 500 ft agl.

## EGTU AD 2.22 – FLIGHT PROCEDURES

- (a) Circuit directions: Runways 05 and 35 - RH; Runways 17 and 23 - LH.

**INTENTIONALLY BLANK**